

ITEM NO.	PART NUMBER	DESCRIPTION	Material	DRAWING #	QTY.
1	BO-1.125 FW	FLAT WASHER 1-1/8"		STOCK	1
2	FP-SP118A-1	SHAFT, SPINNER	CF ANN 4142 1-1/8 RDx 12	90-1601	1
3	HD-PL .4375 HD	7/16 Lynch Pin.		STOCK	1

REVISIONS			
REV.	DESCRIPTION	DATE	APPROVED
B	UPDATED TO MATCH 3D MODEL	12/17/2012	

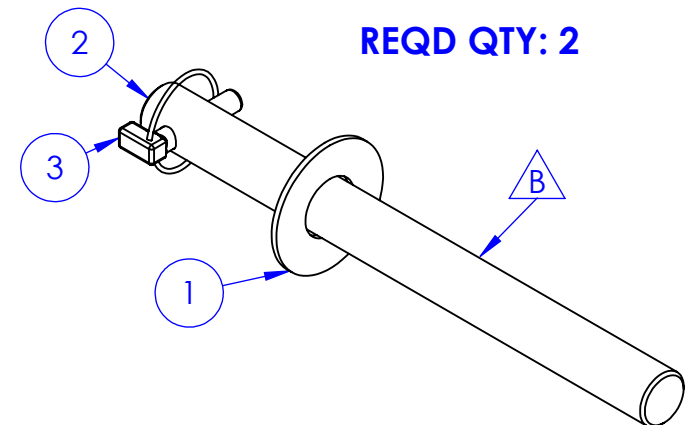
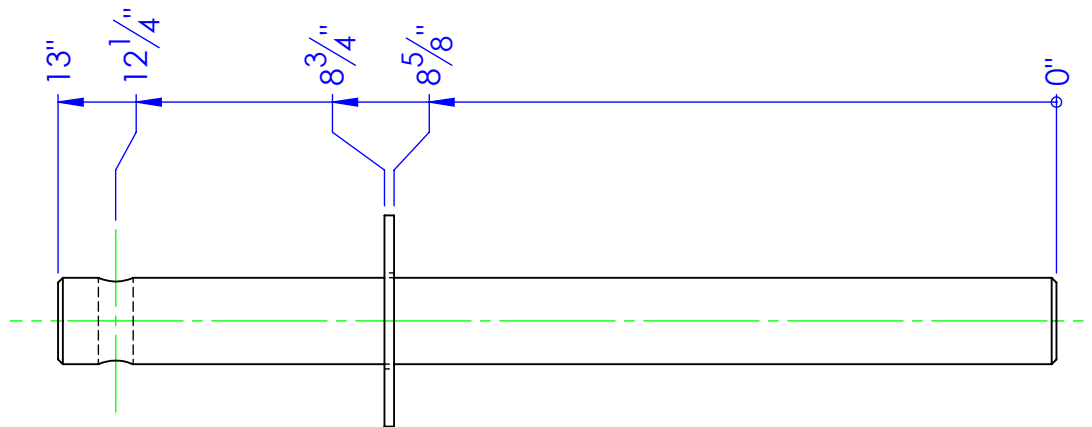
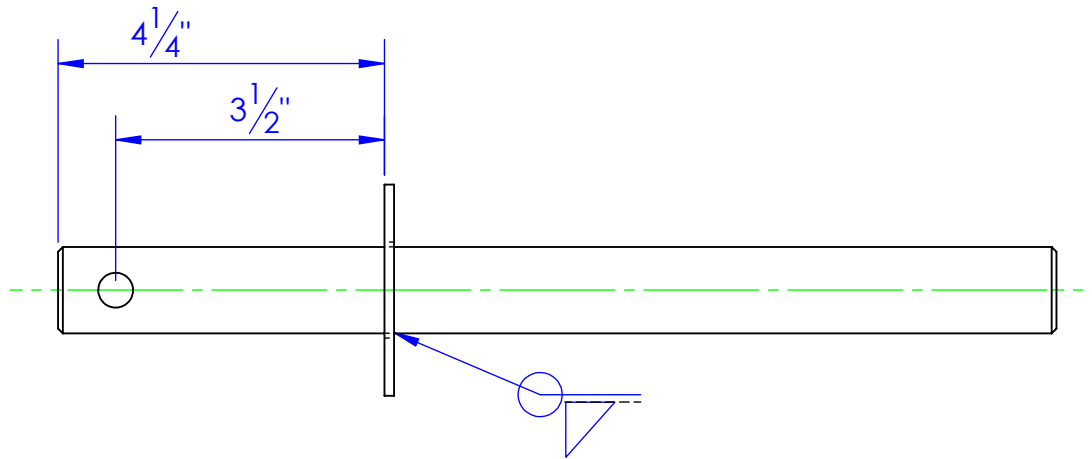

PROPRIETARY AND CONFIDENTIAL
THE INFORMATION CONTAINED IN THIS
DRAWING IS THE SOLE PROPERTY OF TRIPLE
C INC. ANY REPRODUCTION IN PART OR
AS A WHOLE WITHOUT THE WRITTEN
PERMISSION OF TRIPLE C INC. IS PROHIBITED.

DIMENSIONS ARE IN INCHES
TOLERANCES:
FRACTIONAL $\pm 1/16$
ANGULAR: MACH ± 1 BEND \pm
TWO PLACE DECIMAL ± 0.10
THREE PLACE DECIMAL ± 0.005

MATERIAL --
DO NOT SCALE DRAWING

NAME DATE
DRAWN **HEATH** 12/18/2012
PART # **OP-PP-118**
ASM #

COMMENTS:
**100 SERIES,
UNROLLING
PLAIN PINS**

P.O. BOX 248,
SABETHA, KS 66534

TRIPLE C
INC.

SIZE **A** DWG. NO. **90-1606 B** REV. **B**
SCALE: 1:2.5 WEIGHT: 3.94 SHEET 1 OF 1